

How do I... Prepare my Apple Devices for Multifactor Authentication

Compatible Devices:

- Mobile:
 - iOS 12.0 or later for iPhone and iPad
 - iOS 11.0 or later for iPad Pro
 - **5SE and 6 are incompatible.**
- Desktop/Laptop:
 - macOS 10.13 High Sierra and later (including Mojave and Catalina)
- Outlook 2016 and above

Version Checking Computing Device:

1. Click on the Apple menu and select About.

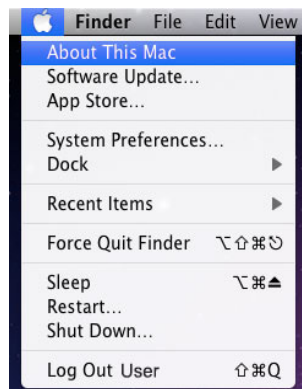

2. Take note of your Mac operating system version. In this example, it's Version 10.15 (19A583).



Version Checking Mobile Device:

1. Click Settings.

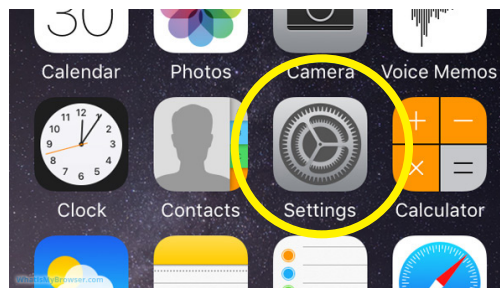

2. Click General > About.

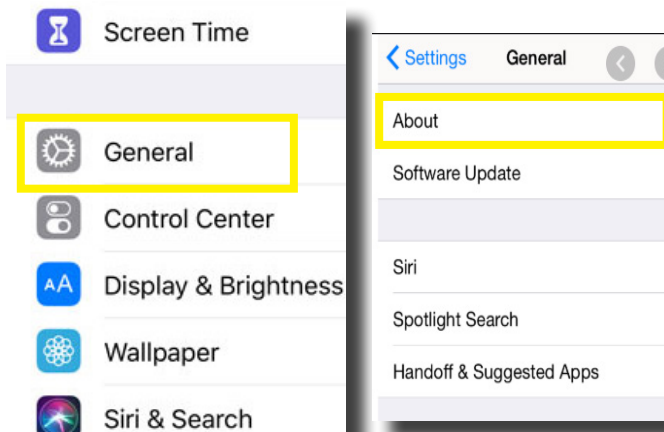

3. Take note of your iPhone/iPad operating system version. In this example, it's Version 13.4.1.

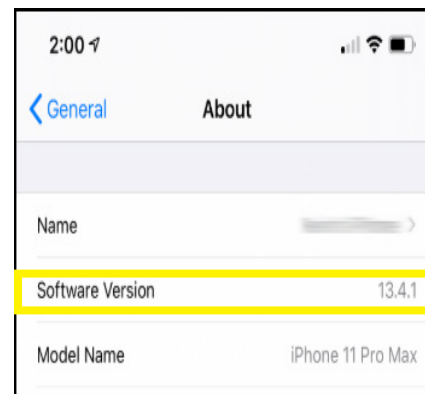

How do I... Prepare my Apple Devices for Multifactor Authentication

Install MS Outlook on Mobile:

1. [Install and register for Duo.](#)
2. Open the App Store.



3. Search for Outlook and select Get > Install.

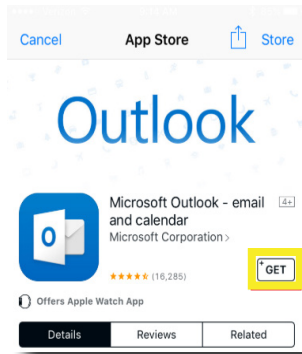

4. Sign in with your Apple ID.

5. Click Open when the app completes installation.

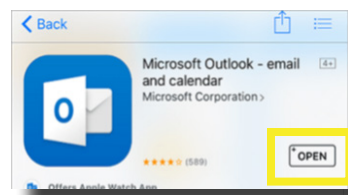

6. Select Get Started on the Home screen.

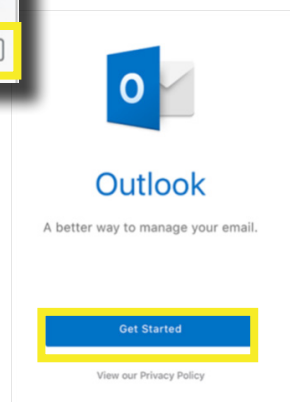

7. On the **Get Notified** screen, select the options (email, calendar invitations, etc.) for which you would like to be notified.

8. On the **Add Email Account** screen, enter your @cuanschutz.edu or @ucdenver.edu email address and select Add Account.

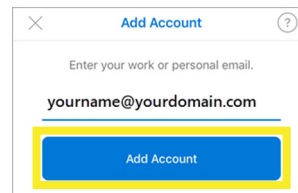

9. On the **Office 365** sign-in screen, sign in to your campus email.



10. Authenticate to your email account using the campuses' Duo Authentication app (should already be installed on your mobile device).

11. Respond to requests for additional setup options.

12. You should now see your campus email begin to sync to your iOS device.



How do I... Prepare my Apple Devices for Multifactor Authentication

Install MS Outlook on Computing Device:

1. Login into [Office.com](https://office.com) with your @ucdenver.edu or @cuanschutz.edu email address to access the MS 365 suite of applications.

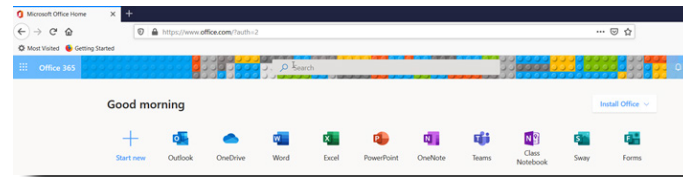

2. Select Install Office > Office 365 apps. *Please note that you will need to install the full MS Office 365 suite of applications to your desktop.*

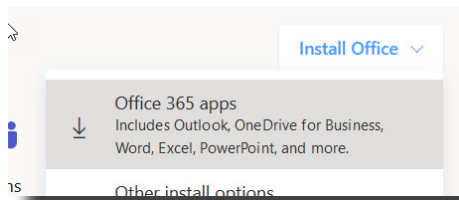

3. Follow the prompts to complete the installation.

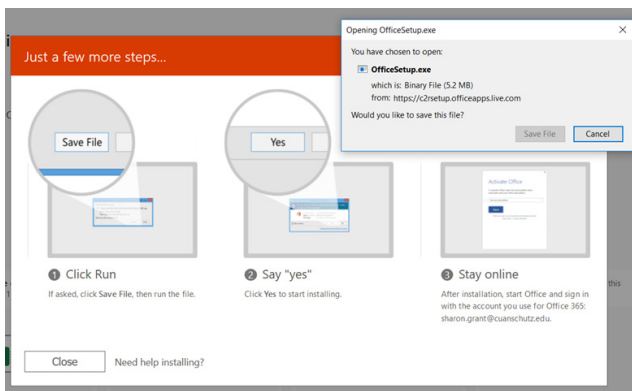

4. Open MS Outlook.

5. On the Outlook menu, click Preferences > Accounts.

6. Select Add Email Account.

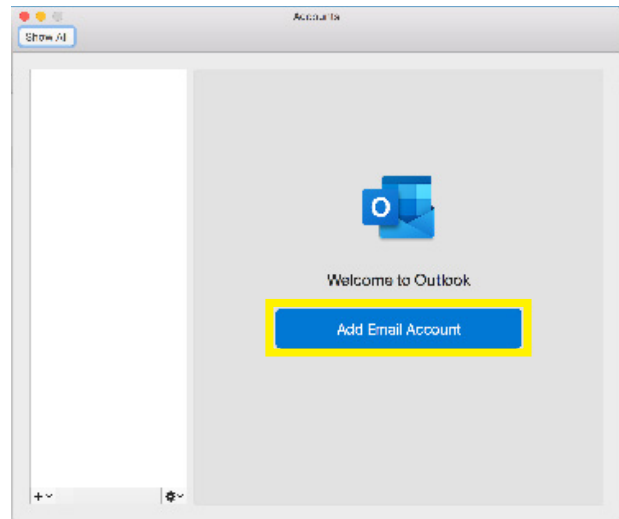

7. Type your @cuanschutz.edu or @ucdenver.edu email address and click Continue.

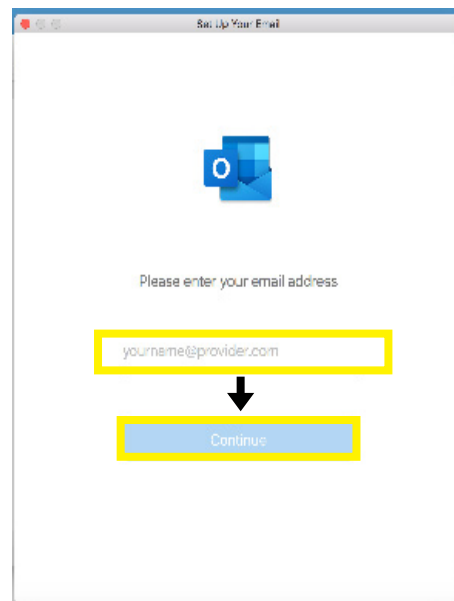

How do I... Prepare my Apple Devices for Multifactor Authentication

Install MS Outlook on Computing Device, cont:

8. You will be taken to the campus' signin page. Sign in with your *network* username and password (not your university email address).

Denver | Anschutz

Scheduled System Maintenance:
OIT will be upgrading the Anschutz Medical Campus firewall network security system to new hardware on Saturday, June 6, from 5 - 9 am. During this upgrade, all CU Denver and Anschutz Medical Campus systems and services will be unavailable.

Web login
Please sign in with your university credentials.

Username or email
anschde

Password

Sign In

9. Complete Duo authentication to the network.

Denver | Anschutz

Choose an authentication method

What is this? Need help?

Duo Push RECOMMENDED Send Me a Push

Call Me Call Me

Passcode Enter a Passcode

10. MS Outlook will automatically sync to your Outlook for MS 365 email account. Click Done.

denver.anschutz@cuanschutz.edu
has been added

Did you know?
Outlook supports Google, Yahoo!, and iCloud accounts.

Add Another Account

Done

Get Outlook for iOS & Android

11. You have successfully completed the installation and your university credentials are configured.

Default Account

denver.anschutz@cu...
denver.anschutz@cuansch...

denver.anschutz@cuanschutz.edu
Exchange/Office 365 Account

Account description: denver.anschutz@cuanschutz.edu

Personal information

Full name: Anschutz, Denver

E-mail address: denver.anschutz@cuanschutz.edu

Authentication

Method: User Name and Password

User name: denver.anschutz@cuanschutz.edu

Password: *****

Advanced...

Technology Links:

- [CU Secure and Multi-Factor Authentication \(MFA\)](#)
- [How to Install and Register for Duo](#)
- [Duo Authentication Secure Website](#)
- [Microsoft 365 Page](#)
- [Microsoft 365 and Duo Security Supported Clients and Browsers](#)

